

Kadey-Krogen 39 *Debadoo*



JEFF MERRILL
YACHT SALES, INC.

3010 Old Ranch Pkwy, Suite 440, Seal Beach, CA 90740
+1 949.355.4950 | www.JMYS.com

Jeff Merrill Yacht Sales, Inc. | 1550 S.E. 17th St., Suite 3 | Fort Lauderdale, FL 33316



Debadoo

Asking: \$349,000.00 Location: Stuart, FL
Active Fin Stabilizers

Kadey-Krogen 39 *Debadoo*

Debadoo is often referred to as the nicest 39 in the Krogen fleet. Equipped with the most desired amenities, lovingly cared for and upgraded at every opportunity, **Debadoo** will provide you unsurpassed cruising comfort and convenience for a yacht this size. In 2017, she underwent a major refit of her navigation and communication electronics including a custom-built dash which rivals the newest Krogens.

Debadoo has proven herself time and again. Recent cruises include: Completing the Great Loop in 2016, Florida to Maine and back in 2017, the Abacos Out Islands in 2018 and NC to Stuart, FL in October 2018 (culminating in a 49 hour offshore run). Now seriously for sale, we do not believe she will last long.

Debadoo has an ideal layout for an active owner operator couple. Her size is large enough for comfortable accommodations, but also appropriate for single handling, economical ownership and maintenance.

The 39's interior layout features a single stateroom and head. The engine room has **standing headroom** forward, for easier service inspections. The raised pilothouse with flybridge above gives a wonderful choice for commanding her underway. The entry level has a comfortable saloon and an excellent offshore galley. Her light teak interior is complimented by Ultra-suede upholstery, custom blinds, teak soles, a soft white overhead and Corian counters.

YACHT NAME:	<i>Debadoo</i>
BRAND AND MODEL:	Kadey Krogen 39 (Flybridge with Bimini top)
TYPE:	Long range passage maker, stabilized. Raised pilothouse
LOCATION:	Stuart, FL
MODEL YEAR:	1998
HULL NUMBER:	3
HULL COLOR:	White gelcoat
REGISTRY:	United States Coast Guard documented 1081866
DESIGNER:	Jim Krogen
BUILDER:	Asia Harbor Yacht Builders Co., Ltd.
HULL MATERIAL:	Solid Fiberglass
DISPLACEMENT:	33,470 lbs. 15.18 MT
BALLAST:	2,000 lbs. 907 KG (Lead)
RANGE:	4,170 NM @ 6 knots; 2,620 NM @ 7 knots
SPEED:	Cruise 6.0 knots. Top 8.0 knots
LOA:	43'8" 13.3 M
LWL:	36'8" 11.2 M
BEAM:	14'9" 4.5 M
DRAFT:	4'3" 1.3 M
D/L:	303
A/B:	2.6:1
Cp:	Prismatic Coefficient .60

Kadey-Krogen 39 Debadoo

AIR DRAFT:	22'0" 33' top of antennae (est.)
DECK:	White deck with beige nonskid
MAIN ENGINE:	John Deere 4045 TFM 115 HP (Main hours: ~4,770) Nov 2018
TRANSMISSION	Twin Disc model MG501 2.39:1 reduction transmission
PROPELLER / SHAFT	1.75" Aquamet 18 shaft 3 blade propeller 26" x 17"
EXHAUST:	Wet exhaust, Centek Vernalift muffler
THRUSTER(S):	TRAC/ABT dual prop 10" 10 HP, 24V DC Bow thruster
STABILIZATION:	NAIAD with 6 sq. ft. active fins with upgrade to adjustable roll and angle
ELECTRICAL:	60 Hertz – US style - 50 amp
SHORE POWER:	50 amp (fore and aft)
GENERATOR:	Northern Lights 8 kW 240V 60Hz (Generator hours: ~3,350) Nov 2018
INVERTER/CHARGER:	Magnum 2800 Watt inverter/ charger
BATTERIES:	Lifeline AGM (2015)
INTERIOR LIGHTING:	Dome type 12V DC Switched at Bulkheads (upgraded to LED bulbs 2017)
CLIMATE CONTROL:	Cruisair air conditioning
MACHINERY EQUIPMENT:	Reverso oil changer
WINDLASS:	Maxwell VWCLP 2200 electric
GROUND TACKLE:	22KG Rocna (Primary) 300 ft. chain; Plow (Secondary) 300 ft. rode
WEAVER LEVER:	Hydraulic dinghy launch system mounted on transom (2014)
TENDER AND OUTBOARD:	AB 10.5 Double Hull Fiberglass Hull RIB Yamaha 15 HP 4 stroke (New 2015)
NAV/COM BRANDS:	Standard Horizon (2017) Green Marine monitors (2017) Bose KVH Simrad
ENTERTAINMENT:	Flat screen TV in master Bose speakers in Pilothouse, Salon, Master and Flybridge 25W Power Amp and 12" Subwoofer mounted under master berth
STATEROOM:	(1) master forward
BEDDING:	Custom mattress in master
HEADS:	Sealand (electric freshwater)
SHOWER:	Single
LAUNDRY:	Bendix Combo clothes washer and clothes dryer
GALLEY:	Force 10 propane 3 burner stove /oven Isotherm virtual frost-free refrigerator/freezer with dual compressors 120/12 V (2018) GE Microwave
INTERIOR WOOD:	Teak
INTERIOR COUNTERS:	Corian counters
INTERIOR UPHOLSTERY:	Ultra Suede
INTERIOR FLOORING:	Teak and spruce hardwood
BILGE PUMPS:	(4) electric standard and (1) electric highwater
TANKAGE: (approx.)	
FUEL:	(2) x 350 gallons= 700 gallons 2650L. (Aluminum 5052) with sight gauges and access hatches. Scrubbed 2017.
HOLDING BLACK:	34 gallons 128 L Sealand 40400 (polyethylene)

Kadey-Krogen 39 Debadoo

FRESH WATER:	300 gallons 1136 L (stainless steel)
ADDITIONAL EQUIPMENT:	(2) Manship ventilation fans in engine room Seagull IV water purifier
SAFETY:	Engine room SeaFire fire suppression Lifesling EPIRB Switlik Liferaft
PHOTO DATE:	Most detail photos were taken in November 2018
Note:	All information is believed accurate, but should be verified.

Description:

Cockpit: The cockpit provides an outdoor space for fishing or relaxing. Enter aft from the swim platform or along either side. You have sole hatch access to the lazarette below. There are shore power connections aft and forward. The walk around side decks (both sides) transit from the cockpit to the foredeck. Access to the interior is through her teak saloon door.

Saloon: The saloon has comfortable bench seating in Ultra-Suede to port and starboard with a moveable high-low teak table. The interior is bright and airy with teak interior joinery and teak parquet floor.

Galley: The galley has been laid out with all of the essentials including a deep basin sink with purified water tap, Isotherm (dual compressor, dual power) refrigerator and freezer (2018). There is overhead storage and ample drawers for glasses, dishes, utensils and silverware. For preparing meals there is a compact microwave oven and a three burner Force-10 propane stove and oven.

Pilothouse: The raised pilothouse has excellent visibility all around and a bench seat, that pulls out to a full size off watch berth. There is an impressive assortment of new (2017) navigation/communication electronics with controls for the stern thruster, engine, and generator. The electrical panel is installed in an easily accessed island panel with clearly labeled breakers and analog gauges. Two pilot house doors open outboard to allow access to the side decks which provides entry to the foredeck or aft to the cockpit. The helm dash was customized to allow for larger displays and a clever folding foot stand has been attached.

Master Stateroom: For comfortable sleeping whether underway or at rest, the master stateroom forward centerline Queen features a large fore/aft island berth. There are hanging lockers to port and starboard with drawers under berth. Deep storage is available under the berth. A flat screen television is mounted aft to port.

Engine Room: Few trawlers under 50' can boast standing headroom in the engine room. You can enter from full size door aft from the lower landing or through the saloon sole. The John Deere main engine is positioned for easy servicing and inspection. The aft section of the engine room has a Northern Lights generator. The forward outboard side yield impressive access to both active fin stabilizers. The aluminum main fuel tanks outboard are plumbed to feed the main engine and generator with supply and return valves. The automatic Fireboy fire suppression system provides additional safety.

Lazarette: Accessed via the cockpit hatch, providing ample storage space for fenders, cleaning supplies and also houses the steering system.

Kadey-Krogen 39 *Debadoo*

Foredeck: The foredeck is high off the water making for a dryer ride and has a Maxwell 2200 electric windlass with chain rode to a Rocna 22 anchor. Chain locker access is through master stateroom hatch. Shore power connections are on the foredeck and in the cockpit.

Boat Deck: Up the ladder from the cockpit brings you to the boat deck and flybridge. There is a covered access hatch to keep the cockpit dry. The boat deck has a mast and boom for launching and retrieving the tender via a wireless remote control. The dinghy is an AB fiberglass bottom, with 15 HP Yamaha (2015) and has been actively used. When the tender is stowed on the transom, this area becomes a large outdoor deck space.

Flybridge: Equipped with single helm chair, port and starboard bench seating, electronics and controls on the dash, covered by a folding Bimini top, the upper helm is the perfect place to operate the vessel on beautiful days.

Debadoo's Weaver Leaver® Dinghy System allows you to launch and retrieve her 4 stroke 15 HP tender in less than a minute. For offshore runs, twin 1500# hoists operated by a single wireless control make storing the dinghy on the boat deck a snap.

Debadoo has been continually refined, proactively maintained with exceptional care and appears much younger than her true age in years. Service records for all major equipment are dutifully logged aboard and available aboard for your perusal.

Highlighted Equipment aboard *Debadoo*

Galley

- Force 10 (3) burner propane stove/oven
- Isotherm dual compressor AC/DC refrigerator/freezer
- Large stainless-steel sink
- Seagull IV water filtration system
- GE microwave oven
- Corian countertops

Electronics

- Raymarine A Series 4G HD radar/plotter (2016)
- Dell Solid State Windows 10 Computer (2017)
- Raymarine i70S Instrument display (2017)
- Raymarine i70S Value Instrument pack (2017)
- Raymarine AIS650 Class B AIS (2017)
- Raymarine CP370 CLEARPULSE Sonar (2017)
- Raymarine SEATALK NG Backbone kit (2017)
- Raymarine Reverse Image camera (2017)
- Raymarine CAM 50 FOR US & CANA (2017)
- (3) Green Marine 19" 1,000 nits monitors (2017)
- Simrad/Robertson AP22 autopilot with flybridge remote
- Simrad/Robertson wired autopilot remote (2000)

Kadey-Krogen 39 Debadoo

- Horizon Standard VHF radio with DSC calling (2017)
- ICOM IC-M422 VHF on flybridge (2008)
- Standard Horizon handheld VHF (2015)
- KVH TracVision4
- Magnavox flat screen TV in master stateroom
- Direct TV/DVR
- Audiovox Sirius satellite radio
- Clarion AM/FM stereo speakers throughout boat

Electrical

- Northern Lights 8 kW generator in sound shield
- Magnum 2800-watt inverter/charger with new controller (2017)
- Balmar 160-amp alternator (2010)
- Balmar 612 three phase external voltage regulator
- ProMariner 24V/30A charger for bow thruster
- Phase Three 12V/40A charger for start battery
- Guest 50A shore ground isolator (2010)
- (3) 8D AGM house batteries (2015)
- 8D AGM engine start battery (2015)
- Optima generator start battery (2018)
- 8D Gel bow thruster batteries (2015)

Engine Room/Mechanical

- John Deere 4045 TFM main engine with Twin Disc 2.39:1 gear
- Walker Airsep air filter (2003)
- Racor closed crankcase vent (2003)
- Racor LFS 802 bypass oil filters for engine and generator
- Naiad Multisea II hydraulic active fin stabilizers (2003 with 2008 upgrade)
- Racor 500 fuel filters for engine and generator
- Gulf Coast fuel polishing system (2000)
- Dripless propeller shaft seal (2013)
- 24V 10HP ABT bow thruster with dedicated batteries and charger
- Reverso 700 oil change system for engine, generator & transmission
- Dual cartridge GE fresh water filters
- Extensive inventory of spare parts
- Bendix combination clothes washer/dryer (not vented)

Safety Gear and Ground Tackle

- Fireboy engine room fire suppression system with engine shutdown
- Lifesling
- Switlik Life Raft in Soft Case (2015)
- CQR 45 lb. anchor with 50' chain and 200' nylon rode
- Rocna 25 anchor with 300' chain

Kadey-Krogen 39 *Debadoo*

- Maxwell electric anchor windlass
- Anchor bridle
- (2) complete sets of dock lines
- Exterior teak brightwork refinished in 2018
- GripTex non-skid on foredecks
- Foredecks repainted 2010

Additional Equipment

- Twin #1500 Power winches on mast for lifting dinghy with single wireless remote control (2015)
- Sunbrella window covers
- Textaline sun/privacy window screens
- Magma stainless steel propane barbecue grill

Exclusions: Owners personal items, art work and tools and deck chairs

Detailed maintenance records confirming pride of ownership are available for review by request*.

The detail photos of *Debadoo* were taken in November of 2018 (many more images are available by request- [contact the listing broker*](#)).

Once you see *Debadoo* in person we are sure you will appreciate her excellent condition and may then be convinced that she is the one for you.

Kadey-Krogen 39 Debadoo

LAYOUT: Pilothouse

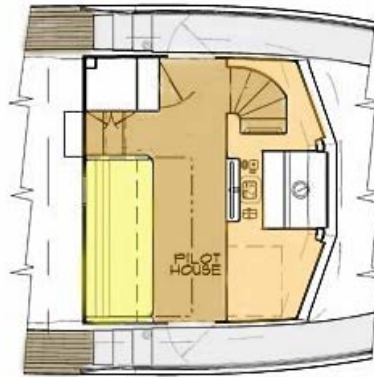

LAYOUT: Boat Deck and Flybridge

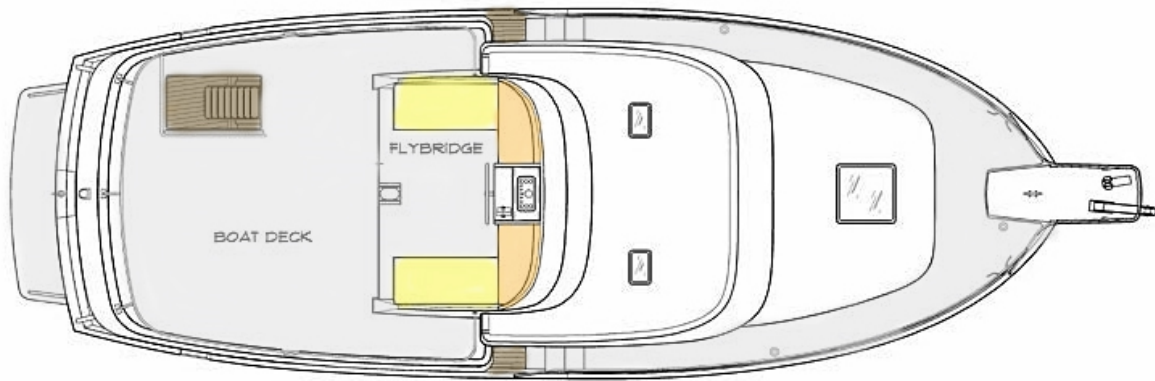

LAYOUT: Main Deck – Saloon, Galley and Lower Deck Stateroom



Kadey-Krogen 39 Debadoo

Exclusions: Potential purchasers should assume that items on the vessel at the time of viewing, but not specifically listed on this sheet, are not included with the sale of the yacht. These specifications are believed to be true and correct but cannot be guaranteed. Items excluded include, but are not limited to Artwork, tools, handheld nav gear and binoculars. Owner's personal effects and clothing will be removed prior to closing.

Disclaimer: Jeff Merrill Yacht Sales, Inc. presents the details of this vessel in good faith but cannot guarantee or warrant the accuracy of this information nor guarantee or warrant the condition of the vessel. Buyers should instruct their agents and their surveyors to investigate all details the buyers desire validated. This vessel is offered subject to prior sale, price change, or withdrawal without notice.

Brokerage: JMYS is a US based (licensed and bonded yacht brokerage in California and Florida) with an international emphasis specializing in ocean capable trawlers. Our brokers are experienced boaters, most are trawler owner/operators with thousands of hours and miles at sea. We treat our clients with respect, we are responsive and not pushy. Our focus is to become your loyal advocate, always looking out for your best interests. The team at JMYS has extensive trawler and motor yacht product knowledge and our skills are available for coaching after the sale has concluded.

Co-Brokerage: Fellow yacht broker association members: This listing is available for co-brokerage and JMYS is a 50/50 house. Courtesy showings are available by appointment. Florida listings subject to appropriate broker licensing required by law.

***Listing broker. Christopher Bruce,** (Licensed Florida Yacht Broker) has extensive product knowledge of the trawler market plus intimate knowledge of the Kadey Krogen's. All inspections are by appointment only. Please contact listing broker, **Christopher Bruce** by phone, text or email for additional information or to schedule your personal showing. Christopher is always available via Mobile +1 603.397.8397 (call or text). You can send a detailed Email to: Christopher.Bruce@JMYS.com.



Mobile phone: +1 603.397.8397 – call or text | Email: Christopher.Bruce@JMYS.com

International Yacht Brokers Association

Yacht Brokers Association of America

